

2024

# BEECHWOOD

St Charbel Maronite  
Catholic Parish Package

280, av. Beechwood Ave., Ottawa - 613-741-9530 -  
[www.beechwoodottawa.ca](http://www.beechwoodottawa.ca)



Beechwood, Funeral, Cemetery and Cremation Services is owned by the Beechwood Cemetery Foundation and operated by The Beechwood Cemetery Company

FE-1071 - Funeral Establishment Operator - Class 1 - CR-02946 - Crematorium Operator - CM-02946 - Cemetery Operator

Established in 1873, Beechwood is recognized as one of the most beautiful and historic cemeteries in Canada; designated as a National Historic Site.

It is the final resting place for over 85,000 Canadians. Beechwood is proud to be the home of the National Military Cemetery, the RCMP National Memorial Cemetery and the Ottawa Police Service Memorial Cemetery. Beechwood has served all cultures and faiths with care and compassion and is proud to have sections designed to meet the interment needs of the Chinese, Egyptian, Greek, Lebanese, Latvian, Muslim, Polish, Portuguese, Ukrainian and Vietnamese communities.



## BEECHWOOD'S MISSION STATEMENT:

“Beechwood, operating on a not-for-profit basis, will be governed efficiently and effectively in the spirit of public service for our community and our nation. Beechwood will ensure that, both at time of need and in perpetuity, it will be operated and maintained in the highest order in memory, honour and respect of those who have left this world before us.”

## \*Care and Maintenance Fund Contribution

### Land:

As required under the Funeral, Burial and Cremation Services Act, 2002 and Ontario Regulation 30/11, the amounts below will be contributed to an irrevocable trust fund known as the Care and Maintenance Fund. Income (interest) from this fund is used to cover care and maintenance expenses of the cemetery in perpetuity.

For one in-ground grave, 2.23m <sup>2</sup> /24ft <sup>2</sup> or larger	40% (or minimum \$290)
For one child or cremation grave, smaller than 2.23m <sup>2</sup> /24ft <sup>2</sup>	40% (or minimum \$175)
For one columbarium niche	15% (or minimum \$165)
For one mausoleum crypt	20% (or minimum \$830)
	<i>(of the purchase price)</i>

### Cemetery Services

#### Weekday Interment Fees (opening and closing of grave)

Interment of an adult at standard depth	\$1580.00
Interment of an adult at extra depth	\$1940.00

#### Saturday Interment Fees (opening and closing of grave)

Interment of an adult at standard depth	\$2230.00
Interment of an adult at extra depth	\$2590.00

#### Weekday Cremated Remains Disposition Fees

Interment of cremated remains (April 1 - December 31)	\$850.00
Interment of cremated remains (January 1 - March 31)	\$1190.00
Inurnment of cremated remains in a columbarium niche	\$675.00

#### Saturday Cremated Remains Disposition Fees

Interment of cremated remains (April 1 - December 31)	\$1500.00
Interment of cremated remains (January 1 - March 31)	\$1840.00
Inurnment of cremated remains in a columbarium niche	\$1325.00

#### Weekday Entombment Fees - Mausoleum Crypts

Entombment in a mausoleum crypt	\$1370.00
---------------------------------	-----------

#### Saturday Entombment Fees - Mausoleum Crypts

Entombment in a mausoleum crypt	\$2020.00
---------------------------------	-----------

\*Excludes The Bereavement Authority of Ontario Consumer Protection Fee - \$30.00 (the fee is applied to EACH service)

The Bereavement Authority of Ontario Fee is charged by the BAO in order to provide its services of information on your options in bereavement services and to regulate the profession making sure the law is consistently followed. Should you have any questions, please visit <https://thebao.ca/>



## Care and Maintenance Fund Contribution - Memorials:

As required under the Funeral, Burial and Cremation Services Act, 2002, the following amounts must be paid to the cemetery operator before a marker is installed. After each marker installation, the amount will be contributed to an irrevocable trust fund known as the Care and Maintenance Fund. Interest from the fund will be used to cover expenses for the care and maintenance of markers and monuments in perpetuity.

For flat markers measuring less than 1,116.13cm <sup>2</sup> / 173in <sup>2</sup>	\$0
For flat markers measuring 1,116.13cm <sup>2</sup> / 173in <sup>2</sup> or larger	\$100
For upright monuments 1.22m / 4ft or less in height and 1.22m / 4ft or less in length, including base	\$200
For upright monuments more than 1.22m / 4ft in height and 1.22m / 4ft, including base	\$400

### Payment, Financing and Funding

#### **For services at time of death:**

Payment is due within 30 days of signing the contract, beyond which interest will be charged at a rate of 1 %, which is equivalent to 18% per annum (APR). Payment may be made by cash, cheque, debit, e-transfer, MasterCard and Visa. Payment plans are available through a third-party credit union. Financing charges apply to payment plans.

Financial assistance for burial and cremation services is available through various governmental agencies, to those who qualify.

#### **Pre-payment in advance of need:**

For services and supplies that are being arranged pre-need, you may pay for the services and supplies at today's price. Pre-paid funds for services will be placed in a trust account, where it will accrue interest until the prepaid contract is fulfilled (when the services and supplies are delivered). Pre-payment can be made by cash, cheque or credit. Funds are held in the purchaser's name.

**Guarantee:** When paid in full in accordance with the payment terms set out in the prepaid contract, the prepaid contract is guaranteed. The total payment(s) made plus interest / growth earned will be applied to the future price of the services and supplies. If the total payment(s) plus interest / growth earned are insufficient to cover the total future price of the prepaid services and supplies, we will absorb the difference as a loss. Any funds in excess of the total future price of the prepaid services and supplies will be returned or applied toward additional services, supplies and disbursements purchased at the time of need, as applicable. Conditions apply. Any changes to the prepaid contract may result in the prepaid contract being null and void and a new contract being executed with current pricing at the time changes are made.

Additional information about payment, financing and funding options is available upon request.

# Beechwood's Lebanese cemetery was the first section to be considered a community cemetery

STEPHEN THORNE  
*Postmedia Content Works*

In 1994, Beechwood Funeral, Cemetery and Cremation Services had a seminal meeting with a monsignor from St. Charbel Maronite Church in Ottawa.

They didn't know it at the time, but the agreement between Beechwood Cemetery and Msgr. Raymond Hanna to set aside a portion of Beechwood's 160 acres for members of the Lebanese-Canadian parish would set a kind of template for the expansion and growth of what would become Canada's national cemetery.

"The idea of creating something specific to what their burial needs would be really was the beginning of our effort to build cemeteries specific to a faith's or community's burial needs," explains James Patterson, Beechwood's director of family services.

Two hundred lots were set aside for the exclusive use of the St. Charbel parish, the first section within Beechwood to be considered a community cemetery.

With immigration from Lebanon accelerating, 200 more lots were set aside in 2003 for parishioners of St. Elias Antiochian Orthodox Cathedral and another 200 for the parish of Saints Peter and Paul Melkite Catholic Church.

As Canada has grown and diversified, so has Beechwood Funeral, Cemetery and Cremation Services.

Inaccurately regarded as Ottawa's Anglo-Protestant cemetery, Beechwood has always reflected Canada's identity as a multicultural, multi-faith society. It always took in whoever needed its services



This statue of St. Charbel Makhlof is the centrepiece of Beechwood's Lebanese cemetery.

RICHARD LAWRENCE PHOTOGRAPHY

and did its best to accommodate a diversity of people of many faiths, languages, cultures and social standing.

Besides Lebanese, Beechwood has sections specifically designed for the Chinese, Egyptian, Greek, Latvian, Muslim, Polish, Portuguese, Ukrainian and Vietnamese communities. Staff speak more than just English and French, including Arabic, Cantonese, Mandarin, Toisan and Chiuchao. Other translators can be arranged.

The Sacred Space is a multi-functional facility conceived after extensive consultations with local religious leaders and the Ontario Multi-faith Council.

Patterson says the arrangements made with Msgr. Hanna "goes to the heart of what we are. We are the Na-

tional Cemetery of Canada now. Had we not brought in all these different churches and communities, it would never have happened.

"They are absolutely essential to the reason why we were named the National Cemetery of Canada in 2007. It shows the cultural mosaic of Canada."

Like other sections at Beechwood, the Lebanese-Canadian cemeteries have their own icon reflecting the beliefs of those who are buried around it — a statue of the Maronite monk and priest, Saint Charbel Makhlof.

The Lebanese graves and those of other Canadians who came from far-off lands reflect not only Beechwood's growth, but the country's.

For more information visit [www.beechwoodottawa.ca](http://www.beechwoodottawa.ca).

# Top 5 Reasons to Preplan Your Funeral

## 1. You want to ease the burden on your family and loved ones.

- If your wishes are unknown when you die, they will be faced with making difficult decisions at a trying time. Will they know if you wish to be buried or cremated? Will they agree on an open or closed casket? Will they agree on how much to spend? Confusion and disagreements are common occurrences when there is no plan to follow. You can avoid this by leaving behind a plan.

## 2. You want your family to have the benefit of a meaningful funeral.

- A funeral is an important event for a grieving family. Psychologically, it provides a sense of closure and enables the family to begin the healing process. Families benefit emotionally and socially by honouring the lives of their loved ones with a fitting ceremony and by giving them a proper send off. It is difficult to make the funeral the best it can be when planning it in a short time.

## 3. You want your final wishes to be followed.

- If you have specific preferences for the disposition of your remains and the nature of your funeral services, you can clearly express them in your funeral plan. You may have a preference for burial or cremation, the epitaph on your headstone, or the music and readings at your funeral. Or you may not want a funeral ceremony. Whatever your wishes, they need to be set forth in your funeral plan.

## 4. You want to be self-reliant and have your affairs in order at the end of your life.

- Taking care of your funeral arrangements is a thoughtful and caring thing to do for your family. It is comforting to know that you have done all you can do to ease their burden. And you can be assured that they will appreciate that your caring for them continued after you are gone.

## 5. You want to assume the financial responsibility for your funeral.

- Planning ahead allows you to make financial arrangements to cover your funeral costs. Even if you are leaving behind sufficient money, will your survivors be able to access it? Preplanning provides you with sound financial planning options you can consider ahead of time.

Price Comparison	2013	2024
Funeral Professional Fee	\$ 5,540.00	\$ 7,655.00
Batesville Lynx (casket)	\$ 1,655.00	\$ 3,450.00
Taxes (HST)	<u>\$ 935.35</u>	<u>\$ 1,443.65</u>
Total	\$ 8,130.35	\$ 12,548.65

Difference: \$ 4,418.30

*\*Disbursements are not included in the comparison (burial permit, flowers, obituary in newspaper)*

6 *\*All prices are subject to change without notice*

# St Charbel Maronite Catholic Parish

## Community Service

This package includes 4 hours of visitation in the Sacred Space in the evening. The Funeral Service and final disposition occur on the following day. (Casket present\*)

### Professional Services and Consultation

Funeral Director Services	\$ 1,975.00
Documentation and Administration	\$ 595.00
Facilities for Shelter (up to 5 days)	\$ 395.00
Basic Preparation of Deceased	\$ 275.00
Professional Embalming Services Estate	\$ 625.00
Settlement Documents	Complimentary

### Transportation (within 50 km)

Transportation of Deceased from Place of Death	\$ 525.00
Funeral Coach	\$ 595.00
Administration / Lead Vehicle	\$ 225.00

### Staff, Equipment and Related Facilities

Staff Services for Visitation	\$ 845.00
Visitation Suite	N / A
Staff Services for Ceremony	\$ 685.00
Visitation with or without a Ceremony in Sacred Space	\$ 915.00

**Total Traditions Package in the Sacred Space** \$ 7,655.00

Batesville Lynx Casket\* \$ 3,450.00

**Total Traditions Package with Casket in the Sacred Space** \$ 11,105.00

**Your 15% Community Discount** -\$1,665.75

**Total Traditions Package in the Sacred Space with Discount** \$ 9,439.25

*\*Please note you may chose any casket available at Beechwood.*

*N.B. Supplies, stationery, cemetery, disbursements and taxes not included.*

*Discount only applicable on the items above mentioned. (not applicable for social service cases)*

Dear Member;

Thank you for your interest in community sections at Beechwood Cemetery. These sections include St. Charbel Church, St. Elias Church, St. Peter & Paul Church and St. George and Antony Orthodox Churches.

Beechwood has a long history with the Arabic Community of Ottawa, serving the community for over 100 years. In 2004, Beechwood Cemetery, along with St. George and St. Antony Orthodox Church, entered into an agreement to set aside an area of the Cemetery for their parish.

The location is within Beechwood Section 110 and is known as the Stations of the Cross. Stations 2 and 3 were set aside and reserved for exclusive use of the parish. Containing more than 150 lots of varying sizes, these locations will be used for many generations of parish members.

To show our commitment to the community, we are offering:

- 15% off the purchase of interment rights (land)
- An addition 5% off for purchasing in advance of need
- An addition 5% off for full payment at time of signing.
- 15% off the purchase of monuments.

To further enhance our service commitment to the community, we will offer 15% off all funeral services and caskets for families from the Churches above, excluding disbursements (flowers, newspapers notice, clergy honorarium, coroner's certificate and municipal death registration).

Our rates will be reviewed and updated on an annual basis beginning January of each year but families will still enjoy nearly 25% off Beechwood's regular rates.

We look forward to serving the Arabic community for many generations to come. If you have any questions or concerns, please do not hesitate to contact us.

Thank you  
Beechwood, Funeral,  
Cemetery & Cremation Services

613-741-9530



## Lots Prices and Discount Table

<u>Size</u>	<u>Regular price</u>	<u>Community Price</u>	<u>Preneed 1</u>	<u>Pre/ Paid-full2</u>
Single grave 3'x10' (3)	\$ 6,720.00	\$ 5,712.00	\$ 5,426.40	\$ 5,140.80
Single grave 4'x10'	\$ 8,845.00	\$ 7,518.25	\$ 7,142.33	\$ 6,766.42
Two grave 6'x10'	\$ 13,440.00	\$ 11,424.00	\$ 10,852.80	\$ 10,281.60
Three grave 9'x10'	\$ 20,160.00	\$ 17,136.00	\$ 16,279.20	\$ 15,422.40
Four grave 12'x10'	\$ 26,880.00	\$ 22,848.00	\$ 21,705.60	\$ 20,563.20

### Monument Examples

All pricing\* includes monument, base, foundation and care and maintenance. \*15% discount already included in the price

#### Single Monuments for 3'x10':

Light Barre Grey monument, Steeled  
22" x 6" x 28" -  
Stanstead Grey base  
24" x 12" x 8"



**\$ 3,650.00 Plus HST**

#### Single Monuments for 3'x10':

Jet Black monument, polished front and back  
22" x 6" x 28" -  
Stanstead Grey base  
24" x 12" x 8"



**\$ 4,650.00 Plus HST**

Families will have to purchase an interment fee (burial of casket) at the time of need or they may pre pay this in advance of need. This first burial will be at extra depth to allow for a second burial at standard depth in the future.

Standard depth interment (excavation of grave at single depth) - \$ 1,580.00

Extra depth interment (excavation of grave at double depth) - \$ 1,940.00

\*Excludes the BAO Consumer Protection Fee - \$ 30.00

### **Payment Policies for Funeral and Cemetery Services:**

Frontline Financial Credit Union has partnered with Beechwood Funeral, Cemetery and Cremation Services to provide loans to our families for the purposes of paying funeral and/or cemetery expenses. Beechwood offers flexible financing and payment options to meet individual needs.

### **Conditions/Features:**

- Loans are available from 1 to 15 years
- Loans are fully open and can be paid off any time without penalty
- Credit Union membership required - \$75 membershares
- Application fee of \$75 waived
- Must be less than 69 years of age to qualify for life insurance
- Pre-existing conditions - 6 months prior and 6 months after
- If joint life insurance coverage is purchased, the loan will be paid in full on the death of either applicant
- Life insurance coverage ends at age 76
- Life insurance premiums are not age banded and are reimbursed on a prorated basis if loan is paid out early
- Payments based on interest rate of 7.99%\*, 5 year renewable term
- On approved credit, some conditions may apply

HST is applicable to all costs associated above. All pricing is not retroactive and cannot be applied to previous purchases. All group rates increase annually beginning the 1st day of January unless otherwise posted. \* Loan rates and prices are subject to change.

# St Charbel Monument - Community Section 100

In 1995, Beechwood and St. Charbel Maronite Church entered into a formal agreement to set aside a portion of Section 100 within the Cemetery for the exclusive use of their parish.

The community build and erected the St-Charbel Monument as the central feature of the St. Charbel Maronite Catholic Cemetery.





# St Charbel Maronite Catholic Parish - New Community Section

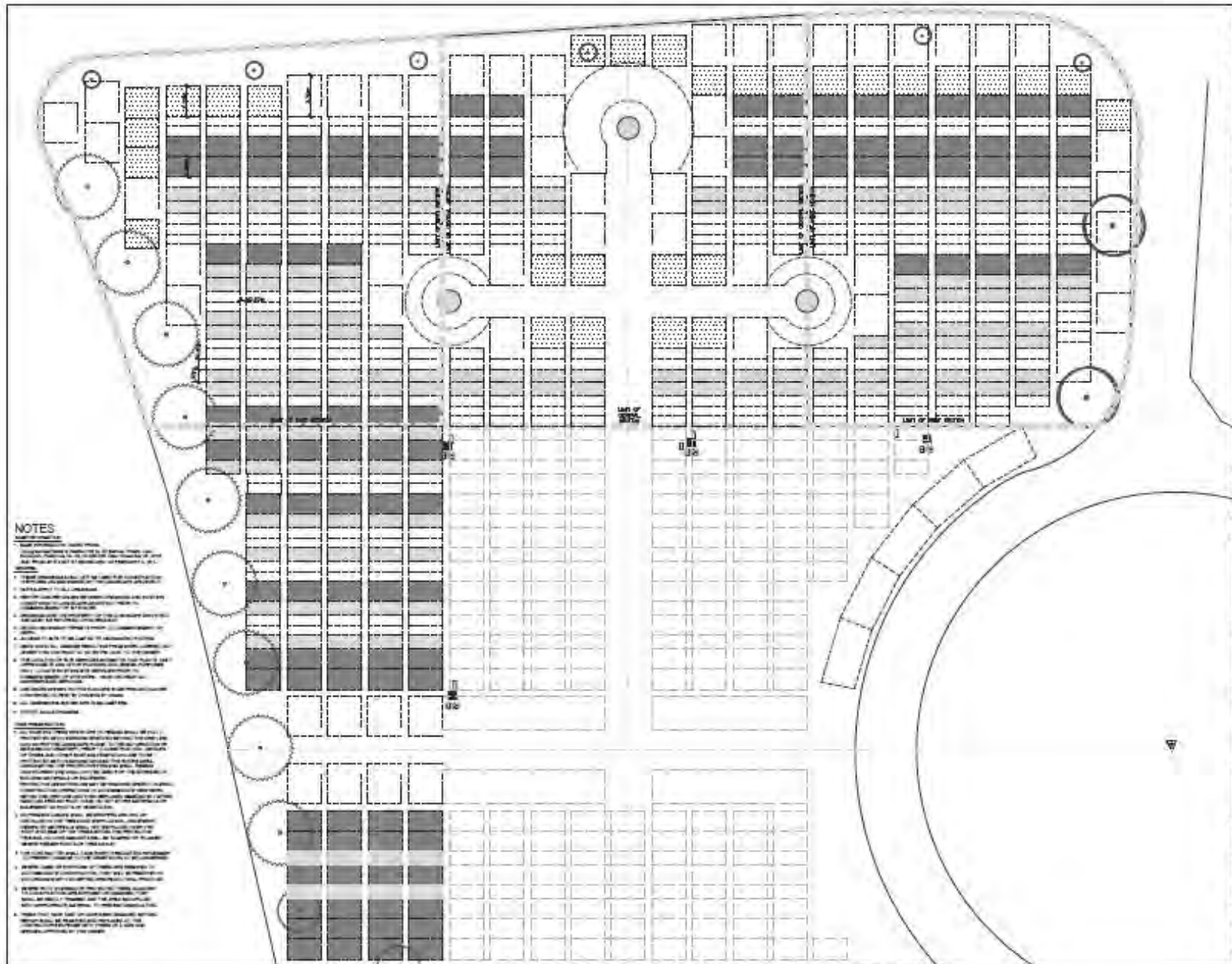

NAME OF DECEASED | NOM DE DÉFUNT \_\_\_\_\_

SECTION | SECTION \_\_\_\_\_

LOT | LOT \_\_\_\_\_

RANGE | RANG \_\_\_\_\_

FOLIO NUMBER | NUMÉRO DE FOLIO \_\_\_\_\_

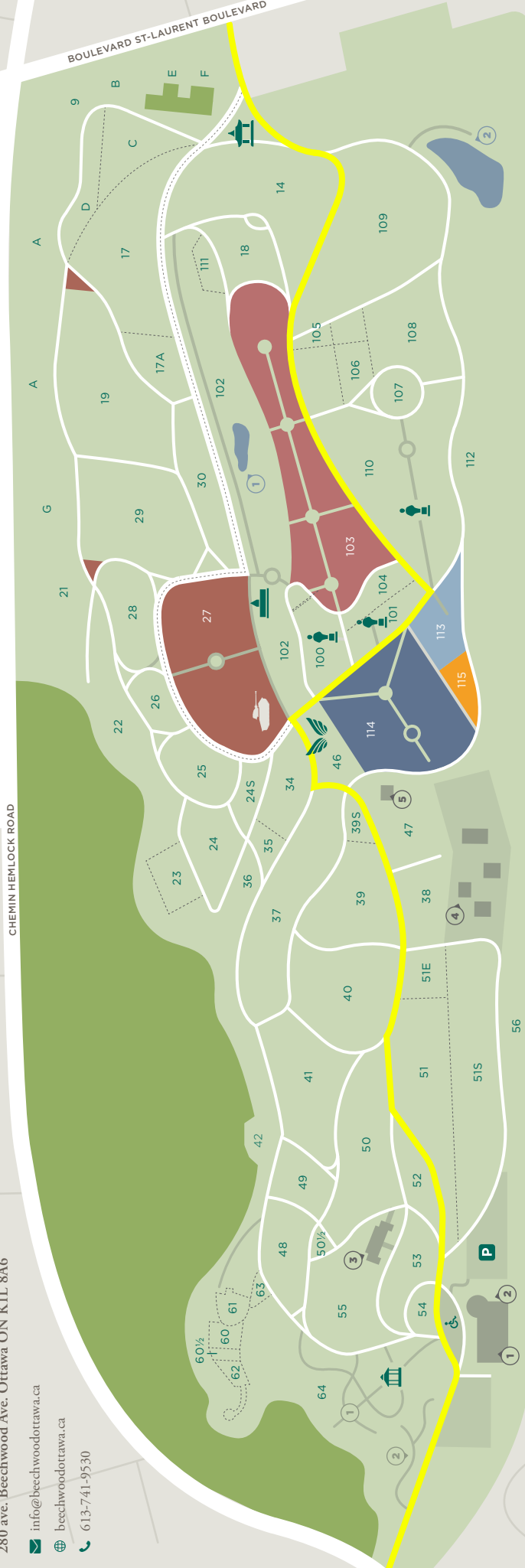

**LEGEND | LÉGENDE**

**LANDMARKS | INSTALLATIONS**

- ① Beechwood National Memorial Centre  
Centre commémoratif national Beechwood
- ② Sacred Space  
Espace sacré
- ③ Mausoleum  
Mausolée
- ④ Crematorium  
Crématorium
- ⑤ Memorial Cross Building  
L'immeuble de la Croix du souvenir

**PATHWAYS | PARCOURS**

- ① Botanical Cremation Gardens  
Jardins botaniques pour crémation
- ② Poet's Hill  
L'aire des poètes

**MONUMENTS | MONUMENTS**

- Tank  
Char d'assaut
- Amicitia France Canada Monument  
Monument Amicitia France Canada
- Garden of Angels  
Jardin des anges
- Pagoda  
Pagode
- Gazebo  
Gazebo

**WATERWAYS | COURS D'EAU**

- ① Quarry  
Carrière
- ② Macoun Marsh  
Marais Macoun
- SECTION 100 | SECTION 100  
St. Charbel  
Saint-Charbel
- SECTION 101 | SECTION 101  
Our Lady of Fatima  
Notre Dame de Fatima
- SECTION 110 | SECTION 110  
Élisabeth Bruyère Monument  
Monument Élisabeth-Bruyère

**COMMUNITIES | COMMUNAUTÉS**

- National Military Cemetery  
Cimetière national militaire
- SECTION 27 | SECTION 27  
Veterans Section  
Section des Anciens Combattants
- SECTION 113 | SECTION 113  
Ottawa Police Service Memorial Cemetery  
Cimetière commémoratif du Service de police d'Ottawa
- SECTION 114 | SECTION 114  
RCMP National Memorial Cemetery  
Cimetière commémoratif national de la GRC
- SECTION 115 | SECTION 115  
CSIS National Memorial Cemetery  
Cimetière commémoratif national du SCRS

**ROUTES | ROUTES**

- Yellow Line | Ligne Jaune
- White Line | Ligne Blanc
- Pathways | Parcours
- Roads | Routes
- Sections | Sections
- Parking | Stationnement
- Off-Property Roads | Routes hors propriété